

Specifications

POST DESCRIPTION

The lighting post shall be all aluminum, one-piece construction, with a classic tapered and fluted base design. The shaft shall be $\varnothing 4"$ fluted.

MATERIALS

The base shall be heavy wall, cast aluminum produced from certified ASTM 356.1 ingot per ASTM B-179-95a or ASTM B26-95. The straight shafts shall be extruded from aluminum, ASTM 6061 alloy, heat treated to a T6 temper. All hardware shall be tamper resistant stainless steel. Anchor bolts to be completely hot dip galvanized.

CONSTRUCTION

The shaft shall be double welded to the base casting and shipped as one piece for maximum structural integrity. The shaft shall be circumferentially welded inside the base casting at the top of the access door, and externally where the shaft exits the base. All exposed welds below 8' shall be ground smooth. All welding shall be per ANSI/AWS D1.2-90. All welders shall be certified per Section 5 of ANSI/AWS D1.2-90.

DIMENSIONS

The post shall be 14'-0" in height with a 17" diameter base. The shaft diameter shall be 4". At the top of the post, an integral 3"x3" tenon with a transitional donut shall be provided for luminaire mounting.

INSTALLATION

The post shall use four, hot dip galvanized L-type anchor bolts to be installed on a 12" diameter bolt circle. A door shall be provided in the base for anchorage and wiring access. A grounding screw shall be provided inside the base opposite the door.

FINISH

Pole to have a black finish.

LUMINAIRE DESCRIPTION

- Utility Arlington LED
 - 70W System, 4k Series CCT
 - Auto-Sensing Voltage 120-277
 - Asymmetric Glass Refractor
 - Spike Finial, Black Finish
 - 20' Prewired Leads
- For complete specifications see LUM_ARUE.

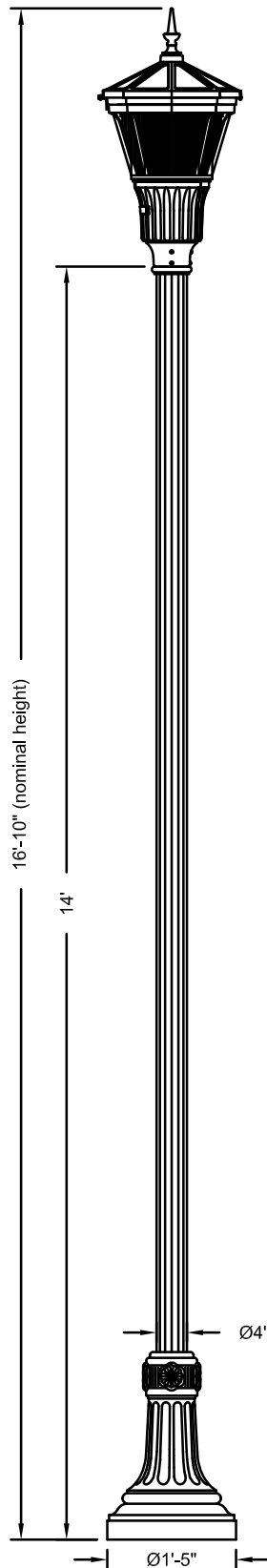

Anchorage Detail

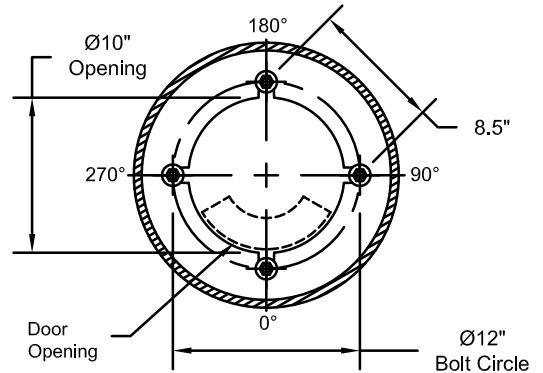

Catalog #'s:

ARUE704KASG3BSL20 - NYA14F4J17P07LABBK



City of Madras Fairgrounds

ORDER #: 2170-11-10181	TYPE:	DRAWING #:
REVISION:	REVISION DATE:	TSG 006720
DRAWN: KRW	ORIGIN DATE: 01/10/12	PAGE: 1 of 1

THIS DRAWING, WHEN APPROVED, SHALL BECOME THE COMPLETE SPECIFICATION FOR THE MATERIAL TO BE FURNISHED BY HOLOPHANE ON THE ORDER NOTED ABOVE. A UNIT OF SIMILAR DESIGN MAY BE SUPPLIED, BUT ONLY AFTER APPROVAL BY THE CUSTOMER IN WRITING. ON POLE ORDERS AN ANCHOR BOLT TEMPLATE PRINT WILL BE SUPPLIED WITH EACH ANCHOR BOLT ORDER TO MATCH THE POLE PROVIDED. THIS PRINT IS THE PROPERTY OF HOLOPHANE AND IS LOANED SUBJECT TO RETURN UPON DEMAND AND UPON EXPRESS CONDITION THAT IT WILL NOT BE USED DIRECTLY OR INDIRECTLY IN ANY WAY DETRIMENTAL TO OUR INTERESTS, AND ONLY IN CONNECTION WITH MATERIAL FURNISHED BY HOLOPHANE.