

# MADRAS PARKS MASTER PLAN

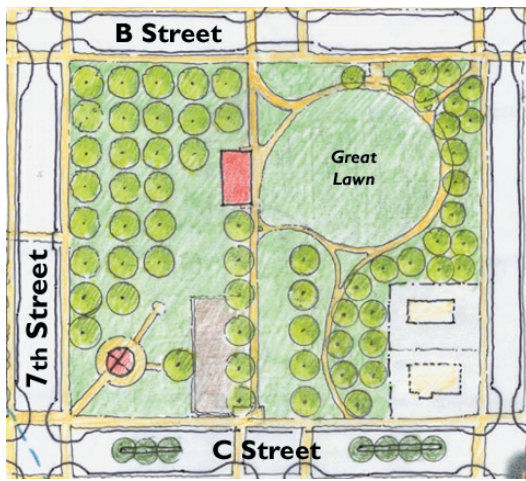

A Concept for the expansion of Sahalee Park onto the vacant block to the east.

Parks, open space and recreation facilities are essential elements of every community. Parks play an important role in providing children with safe and educational play activities, give adults areas for constructive exercise, provide escape from urban stress, and may provide viewing opportunities for a wide range of flora and fauna while protecting sensitive open spaces. They have also been proven to enhance nearby property values.

As Madras grows and land is developed for housing, commercial and industrial activities, open space and outdoor recreation opportunities will be lost without long-range planning. Madras has an excellent window of opportunity now to create a lasting legacy of parks and open spaces that serve the City as it shares in Central Oregon's remarkable growth and prepares for new residents and jobs. If Madras wishes to attract new jobs and housing, the improvements detailed later in the Master Plan can help proactively improve the City's quality of life and ensure that the current jobs/housing imbalance is redressed, encouraging employees of Madras-based companies and agencies to live in the City instead of commuting from Redmond and Bend. This, in turn, can help to revive the commercial economy and tax base of Madras.

## Goals of this Parks Master Plan

- Enhance Madras' community livability
- Complement future growth with community amenities
- Promote health and fitness throughout the community
- Renovate existing parks to modern standards
- Distribute recreational resources equitably through the community

## Public Comments

The following is a list of public comments from workshops, interviews and the survey, many of which have been integrated into the long-range action plan:

- Create a loop trail around the City of Madras
- In all neighborhoods, develop Pocket Parks, especially new developments
- On east side, develop a park along with a golf course on Zemke Property
- "We need to develop a West Madras Park"
- Acquire open space in the floodway and floodplain — expand the linear park along trail
- Expand Sahalee Park across 9<sup>th</sup> Street and develop as a unified park
- Landscape vacant lots as they do in Cannon Beach - with benches and wildflowers
- Build a soccer field in underutilized spaces like the public works yard
- Move fairgrounds up to industrial park at airport; develop old fairgrounds with low-income housing and a park
- Acquire open space near Highway 26 at the Airport
- Maybe create park space on the old Copeland lot
- Build a new park behind Miller Hardware – empty, huge lot; new street
- A group has approached Deschutes Valley Water to make a "stopping spot" for celebration of water. This would be a place for RVs to stop and fill with water and public dumping station – into city sewer?
- Parks don't need so much concrete paving—this defeats the purpose; there's a huge entrance to high school, with so much concrete. The middle school has a huge area for basketball hoops, but no green lawn!
- Friendship Park should have more facilities, and Elementary School fields developed as part of a new civic center.
- Purchase open space on bluffs overlooking town on either side of Willow Creek Canyon—don't let it get developed.

## Key Recommendations

In general, there are some **big ideas** for improving the Madras parks and open space system, as well as some **simple, cost-effective steps**. If some visions for mitigating the threat of Willow Creek flooding are pursued, there could be a significant and unique greenway weaving through the heart of the city. At very least, the existing Willow Creek Trail should be completed to link eastside Madras amenities with Willow Creek Canyon, but there are opportunities for a **city loop trail**, if acquisition proceeds now, before major growth occurs. This trail should be 'buffered' by as much green space as the city can afford to purchase along the Willow Creek main channel. Additional land in the southern and northern regions of the City should be obtained to redress the apparent lack of open space in these neighborhoods. It is suggested that two to four more park sites, consisting of at least one acre per site, be obtained as a minimum.

With the lack of sidewalks in the City it is recommended that, in addition to working to complete pedestrian facilities in town, several smaller parcels, some of which are already in public ownership, and within easy and safe walking distance for local residents, should be developed as neighborhood parks. One easy strategy would be the simple addition of play structures and landscape enhancements to apartment complexes or existing pocket parks which have been dedicated to the city within new subdivisions.

With a growing Hispanic population, there is a demand for more soccer fields in Madras, perhaps behind the County Fairgrounds or behind the Public Works yard. These could be quickly built if water for irrigation is supplied, but indications are that players will accept any form of field. There is also a demand for more basketball courts. These can be installed in many parks and schoolyards, even on vacant commercial property.

## Specific Actions and Costs for the next 5 years

**Expand Sahalee Park \$675,000**

**North Y Landscape \$500,000**

**Expand and Upgrade Bean Park \$70,000**

**Upgrade Willow Creek Trail surface \$60,000**

**Connect Willow Creek Trail across the City \$132,000**

**Add a downtown pocket park \$45,000**

**Build a Skate Park with general park space surrounding \$750,000**

**Add one soccer field to Westside Park or Public Works yard \$100,000**

**Upgrade neighborhood park \$60,000**

**General Maintenance \$217,000**

**Estimated Costs for 2004-2010 Actions = \$2,600,000 (of which \$1,700,000 eligible for SDCs)**

**Recommended SDC level for 2004-2010 = \$1766 (in 2004 dollars)**



Willow Creek Trail could be continued easily along the north creek bank, following the bed of an informal trail



Soccer Fields south of Buff Street



Future COCC site from Middle School



Bean Park Basketball Court

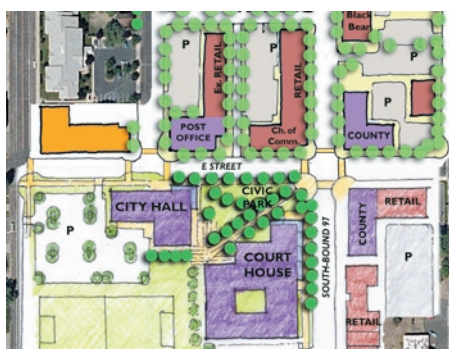

Potential scheme for downtown Madras redevelopment that creates a new Civic Center at the present site of Friendship Park, with City Hall and Jefferson Co. Courthouse looking onto a new Civic Square.

*All agree that parks not only add to the beauty of a city and to the pleasure of living in it, but are exceedingly important factors in developing the healthfulness, morality, intelligence, and business prosperity of its residents. Indeed it is not too much to say that a liberal provision of parks in a city is one of the surest manifestations of the intelligence, degree of civilization and progressiveness of its citizens.*

*Olmsted Brothers*

*Walker Macy, October, 2004*